

**PEDRALI®**

# PLANO PL



DESIGN:  
PEDRALI R&D

Plano is a collection of tables for the office that satisfies the aesthetic and functional needs of contemporary work environments. Table available in different sizes with two round or square steel bases and oval or rectangular solid laminate top. Also available with the cable management.

INFORMATION REQUEST



Art. PLR\_240X120/140

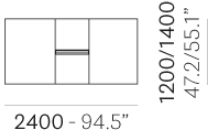

Art. PLR\_300X120/140

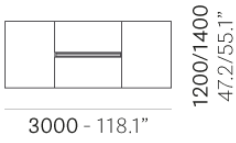

Art. PLR\_360X120/140

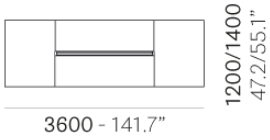

Art. PLO\_240X120/140

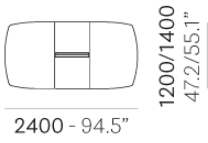

Art. PLO\_300X120/140

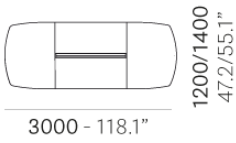

Art. PLO\_360X120/140

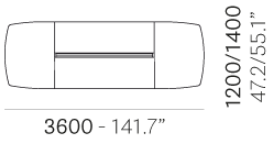

TOP FINISHES



FRAME FINISHES



FINISHES AND MATERIALS

**PEDRALI®**

# PLANO PL2



DESIGN:  
PEDRALI R&D

Plano is a collection of tables for the office that satisfies the aesthetic and functional needs of contemporary work environments. Table available in different sizes with two square steel bases and ultra-thin solid laminate top supported by a die-casted aluminium frame. Also available with the cable management.

INFORMATION REQUEST

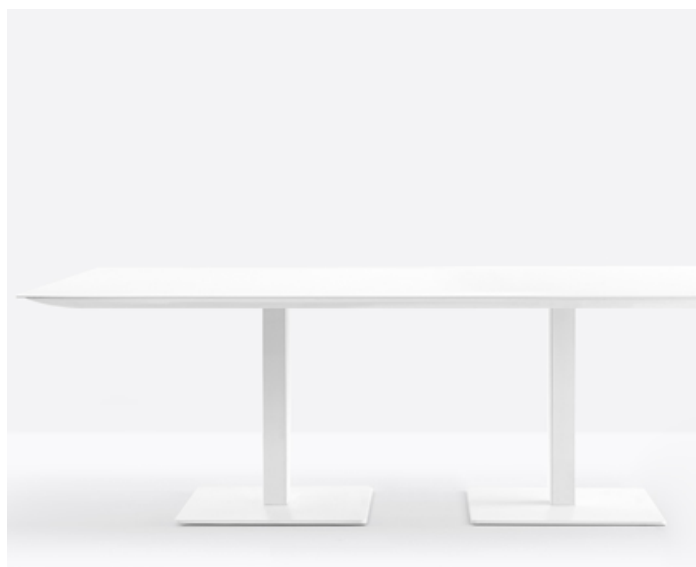

Art. PL2/CC

2400/3000/3600  
94.49/118.11/141.73"

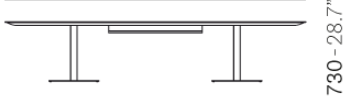

730 - 28.7"

600x600 - 23.6x23.6"

1000x42/60 - 39.4x1.7/2.4"

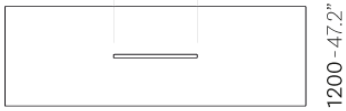

1200 - 47.2"

Art. PL2

2400/3000/3600  
94.49/118.11/141.73"

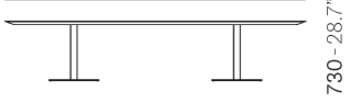

730 - 28.7"

600x600 - 23.6x23.6"



1200 - 47.2"

Table PLANO 2

TOP FINISHES



CFC\_BI

FRAME FINISHES



BI



AC

FINISHES AND MATERIALS

PRESS