

# Audo

COPENHAGEN



ANDROGYNE LOUNGE TABLE, CALACATTA VIOLA  
Designed by *Danielle Siggerud*

ANDROGYNE LOUNGE TABLE, CALACATTA VIOLA  
Designed by *Danielle Siggerud*

*Introducing Audo's Androgyne Lounge Table  
in striking Italian marble.*

Part of Copenhagen-based Norwegian architect and designer Danielle Siggerud's Androgyne Collection for Audo, the artistic lounge table profiles harmonious proportions and elegant natural materials. The latest iteration of the popular design is crafted in Calacatta Viola marble, a beautiful off-white marble with characteristic purple veining. Honouring craftsmanship tradition and modern living, its sculptural form adds an artistic silhouette to any room.

Both top and base are available in the Italian marble, making it possible to mix and match with other materials in the collection – including Kunis Breccia stone and a range of wood types and finishes – to create an expression to suit any space and style.

*“The versatile piece lets you create personal spaces suited to the context, place and function it will become a part of,”* notes Danielle Siggerud.

The Androgyne Lounge Table is both purposeful and powerful when placed everywhere from hotel lobbies and private living rooms to exhibition spaces and office reception areas. Its versatile design does double duty as a lounge table or bench for piles of books or decorative objects.

*About the designer*

Danielle Siggerud is a Norwegian architect based in Copenhagen. She holds an MAA from the Royal Academy of Fine Arts in Denmark and has previously worked with renowned architect John Pawson in London. She established her Copenhagen studio in 2016.



PRODUCT TYPE  
Lounge table

ENVIRONMENT  
Indoor

DIMENSIONS

H: 37,8 cm / 14,9"  
W: 120 cm / 47,2"  
D: 45 cm / 17,7"

COLOUR

*Tabletop*  
Calacatta Viola marble

*Base*  
Natural oak  
Dark stained oak  
Walnut  
Calacatta Viola marble

MATERIALS

Calacatta Viola marble, MDF, oak or walnut veneer, powder coated steel, PA plastic glides

ANDROGYNE LOUNGE TABLE, CALACATTA VIOLA  
Designed by *Danielle Siggerud*



## ABOUT DESIGN HOLDING



Design Holding is a global leader in high-end design with a cultural heritage of European origin, characterised by multi-channel distribution and diversified product categories. Guided by the purpose '*We design for a beautiful life*', the Group designs for the planet, people, and culture. The Group includes Flos, B&B Italia, Louis Poulsen, Maxalto, Arclinea, Azucena, FENDI Casa, Menu, by Lassen and Lumens.

Design Holding's catalogue features iconic objects designed by world-famous designers such as Achille and Pier Giacomo Castiglioni, Tobia Scarpa, Luigi Caccia Dominioni, Poul Henningsen, Arne Jacobsen, Antonio Citterio, Gaetano Pesce, Philippe Starck, Piero Lissoni, Konstantin Grcic, Jasper Morrison, Patricia Urquiola, Michael Anastassiades and many others. Design Holding is jointly owned by the global investment firms Investindustrial and Carlyle.

## ABOUT AUDO COPENHAGEN



Audo Copenhagen is a luxury source for high-end design furniture, lighting and accessories reflecting Danish heritage and a contemporary, global outlook.

The brand actively partners with leading architects and interior designers from around the world including Norm Architects, Colin King and Danielle Siggerud and stewards iconic designs including the timeless Kubus collection by architect Mogens Lassen, The Tired Man by Flemming Lassen and the Plinth Collection by Norm Architects.

# Audo

COPENHAGEN



ANDROGYNE SIDE TABLE, Ø40  
Designed by *Danielle Siggerud*



ANDROGYNE SIDE TABLE, Ø40  
Designed by *Danielle Siggerud*

Perfectly proportioned, the Androgyne Side Table balances a rounded marble tabletop on a powder coated steel base that features wide, flat legs, laser-cut for precision. The architect-designed piece is offered in a number of materials that can be co-ordinated or contrasted as desired. The latest addition to the collection is a tabletop in Emperador marble, a richly veined marble with intense brown tones, as well as calcatta viola, already known from the Plinth Collection. Carefully selected for its inherent beauty and light-reflecting qualities, the different marble tops provide a top provides a tactile and natural contrast to the sleek metal.



PRODUCT OPTIONS

*Tabletop*



CRYSTAL ROSE MARBLE

NERO MARQUINA MARBLE

CALACATTA VIOLA MARBLE

EMPERADOR MARBLE

*Powder coated steel base*

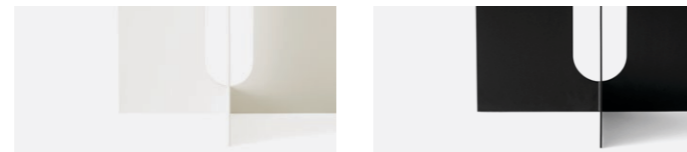

IVORY STEEL

BLACK STEEL

TECHNICAL SPECIFICATIONS

PRODUCT TYPE  
Side table

COLLI  
1

Environment  
Indoor

DIMENSIONS

*Steel base*  
H: 43 cm / 16,9"  
Ø: 40 cm / 15,7"

*Steel base with marble top*  
H: 44,8 cm / 17,6"  
Ø: 42 cm / 16,5"

PRODUCTION PROCESS

Welded CNC-cut steel sheet with powder coated finish. The table top are CNC milled and treated with a sealer.

COLOUR

*Marble top*  
Crystal Rose  
Nero Marquina  
Calacatta Viola  
Emperador

*Base*  
Black (RAL 9005)  
Ivory (NCS S 1002-Y50R)

MATERIALS

Powder coated steel and Crystal Rose marble, Nero Marquina marble, Calacatta viola marble or Emperador marble.

GLOSS  
Gloss 5-10

WEIGHT

Marble top: 6,9 kg / 15,2 lb  
Steel base: 9,7 kg / 21,4 lb

TEST  
N / A

CERTIFICATIONS  
N / A

PACKAGING TYPE  
Gift box

PACKAGING MEASUREMENTS  
(H × W × D)

*Marble top*  
16 cm × 49,5 cm × 49,5 cm /  
6,3" × 19,5" × 19,5"

*Steel base*  
49 cm × 43 cm × 43 cm /  
19,3" × 16,9" × 16,9"

MATERIALS & MAINTENANCE  
Please visit [audocph.com](http://audocph.com) for materials, care and maintenance instructions.

STEEL BASE

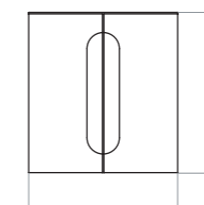
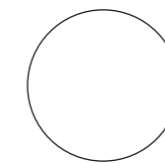

Ø: 40 cm / 15,75"

H: 43 cm / 16,9"

STEEL BASE WITH MARBLE TABLETOP

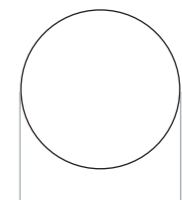

Ø: 42 cm / 16,5"

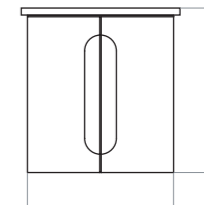

Ø: 40 cm / 15,75"

H: 44,8 cm / 17,6"